



**GREEN** *Living*  
Designs  
**GLOBUS** *Sustainable*  
Construction



Green Living Designs & Globus Construction  
in partnership with

NLH Landscape Architects  
presents

## *Green Garden on First Street*

A public park designed with the latest in  
sustainable materials and technology



# Existing Space

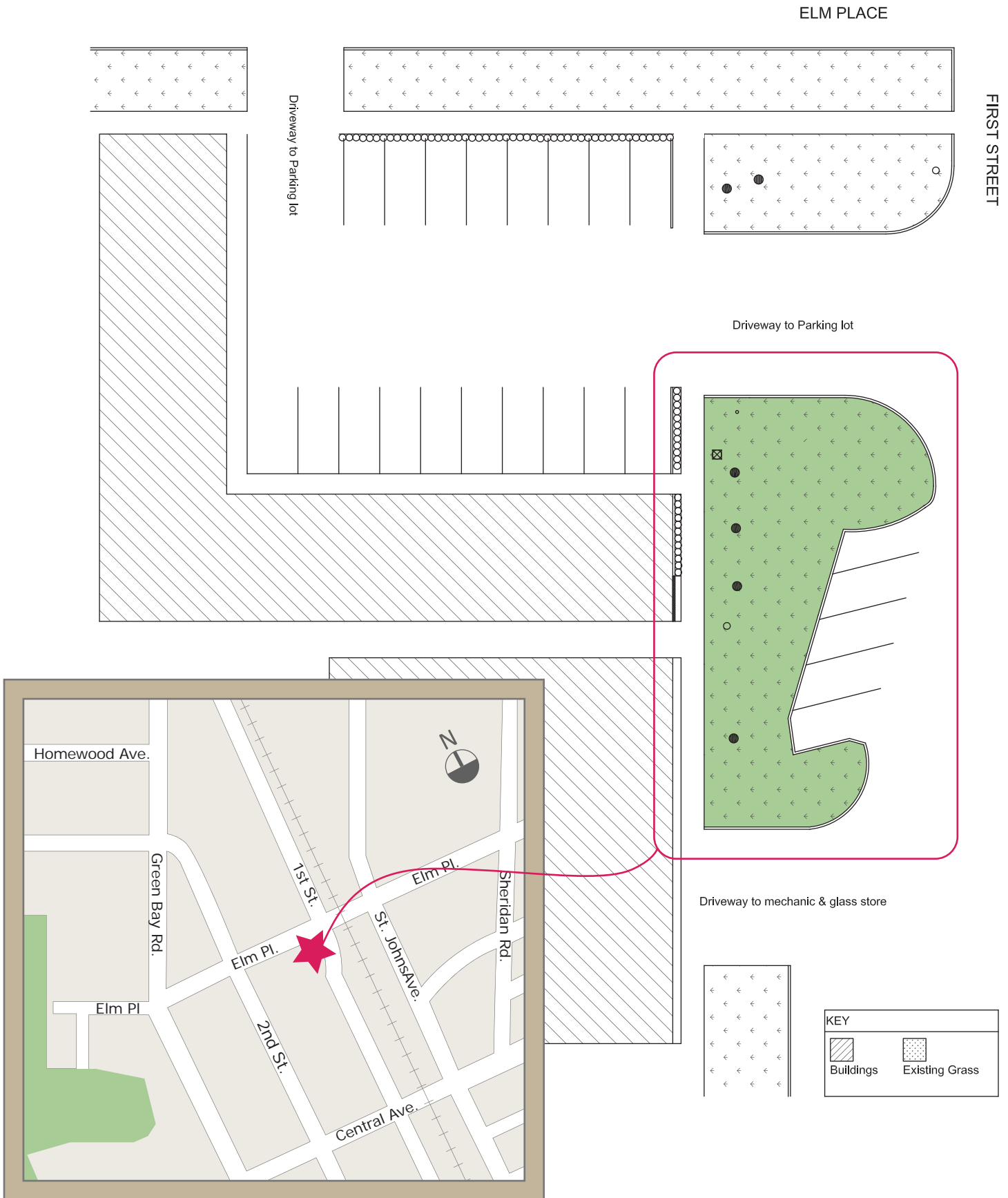

# Existing Space

- An irregularly shaped turf space at the corner of Elm Place & First Street in Highland Park
- Lot is approx. 50' x 95', with a total of approx. 3000 sq. ft. when lot profile is accounted for
- Partially shaded by several mature Honeylocust trees
- In the summer of 2010, the Highland Park Downtown Alliance placed two art benches in the space that were crafted by faculty members of the Art Center. Their daily use demonstrated that the public would welcome this space for outdoor gathering.

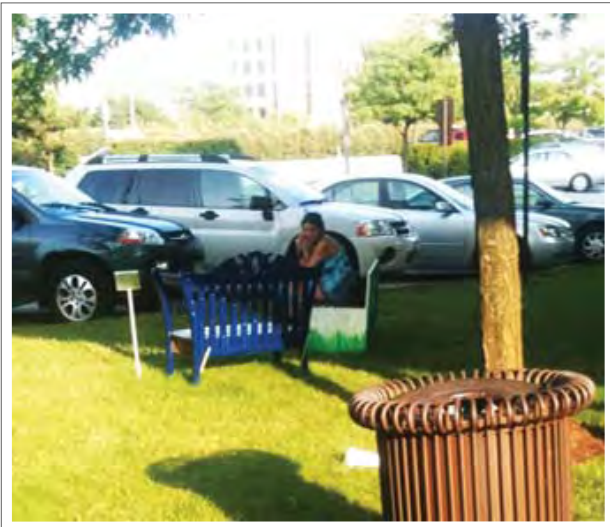

# Goals

- To promote Highland Park's Sustainability Plan
- To promote and expand the mission of the Cultural Arts Commission
- To create a demonstration site to educate the community about eco-smart products, technologies and practices
- To expand the downtown open green spaces further north
- To create a "gateway" into the more pedestrian friendly downtown
- To positively affect adjacent property values, ability to lease and attract quality tenants
- To increase foot traffic for local businesses
- To provide space for community gathering thereby enhancing community spirit

# *Sustainability*

- Recycled Materials
- Native / indigenous plants
- Prevents storm water run off
- Filters rain water before it enters the water treatment system
- Utilizes solar technology to supply power for pumps and lighting
- Promotes recycling in the downtown district
- Fosters community interaction
- Reduces Highland Park's environmental footprint

# Proposed Plan

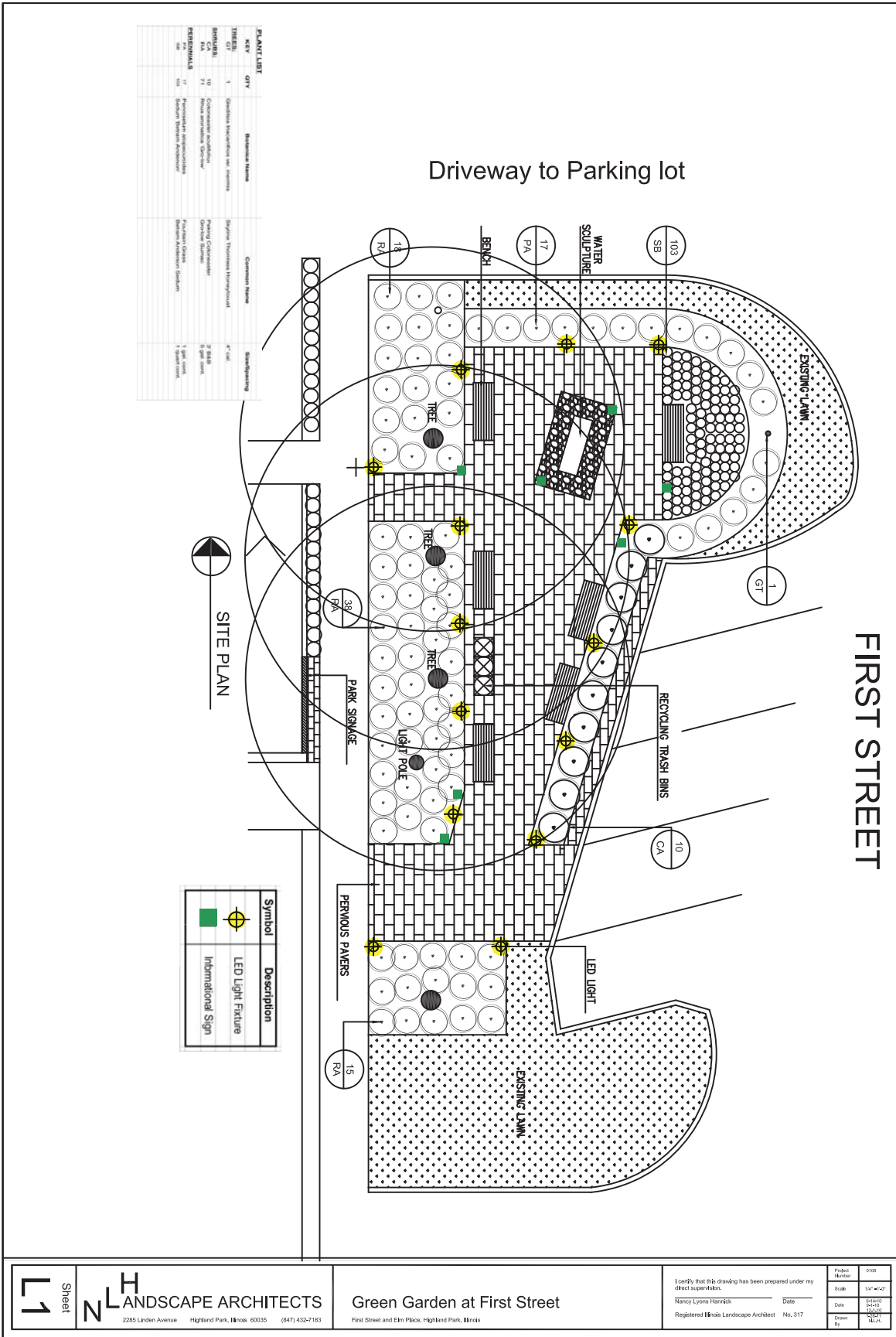

KEY	QTY	Botanical Name	Common Name	Size/Spacing
TREES	1	Quercus macrocarpa var. prinus	Baytown Hickory	4" x 4"
SHRUBS	10	Conocarpus erectus	Palmetto	2' x 2'
PERENNIALS	21	Phlox paniculata	Phlox	18" x 18"
PERENNIALS	21	Hydrangea macrophylla	Hydrangea	18" x 18"
PERENNIALS	21	Andromeda japonica	Andromeda	18" x 18"

Symbol	Description
	LED Light Fixture
	Informational Sign

# Proposed Plan

Driveway to Parking lot



FIRST STREET

# *Sculpture Design: Inspiration*

- Much of the design for the sculpture was inspired by the varied and unique geology of Highland Park and the surrounding land forms. The peak of the arch recalls the peak of the bluff where Highland Park is situated, and that gives the city its “Highland” name. The cascading water represents the formations of the ravine that channel water down and away from the city, into Lake Michigan. Additionally, we were inspired by the images of arches, water and sailing that are often seen repeated throughout the city and it’s organizations.



• Highland Park Chamber of Commerce Logo



• Highland Park City Seal



• The Alliance Logo



• Union Pacific Train Arch



# *Sculpture Design: Bluff*

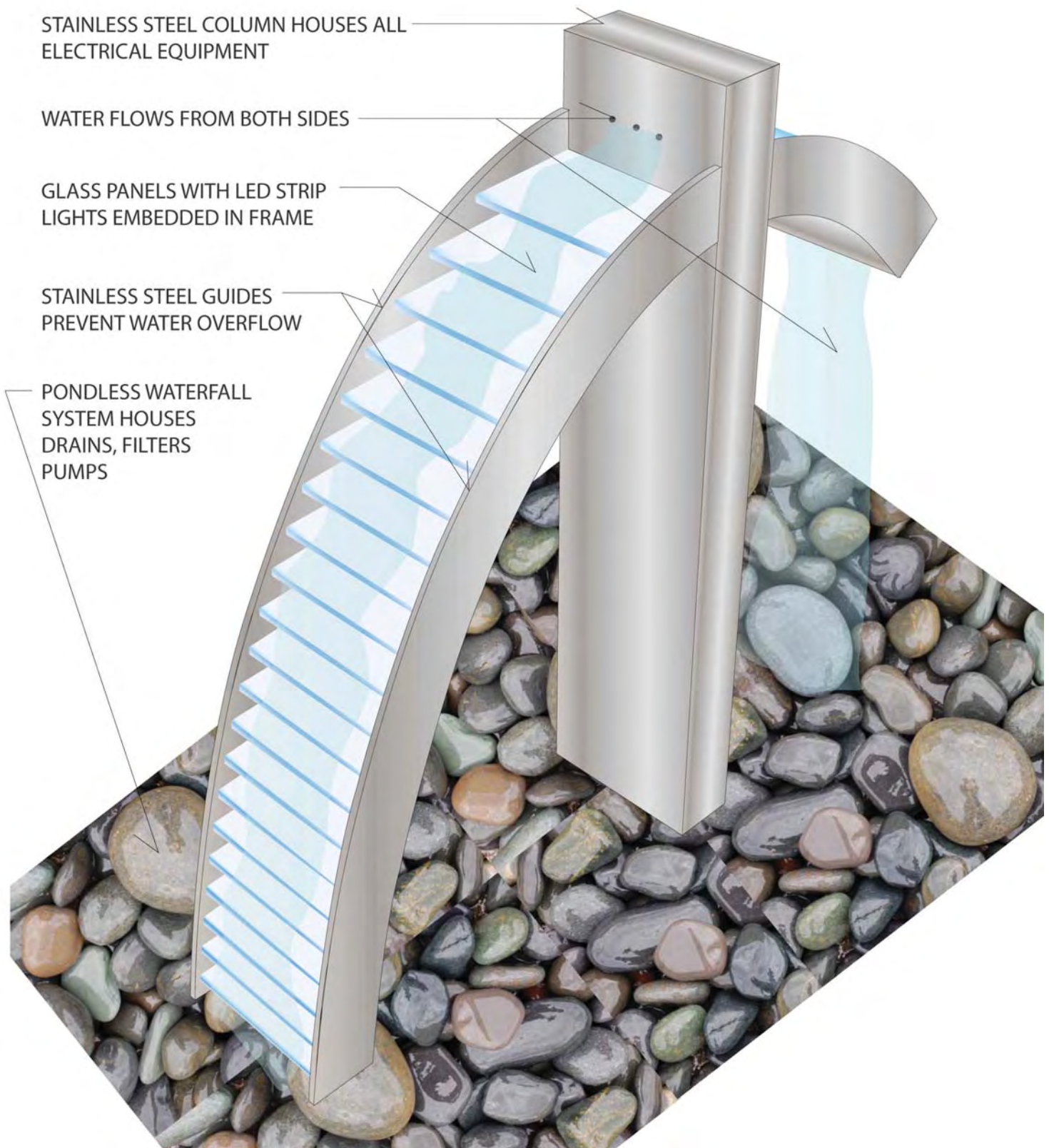

# *Sculpture Design: Bluff*

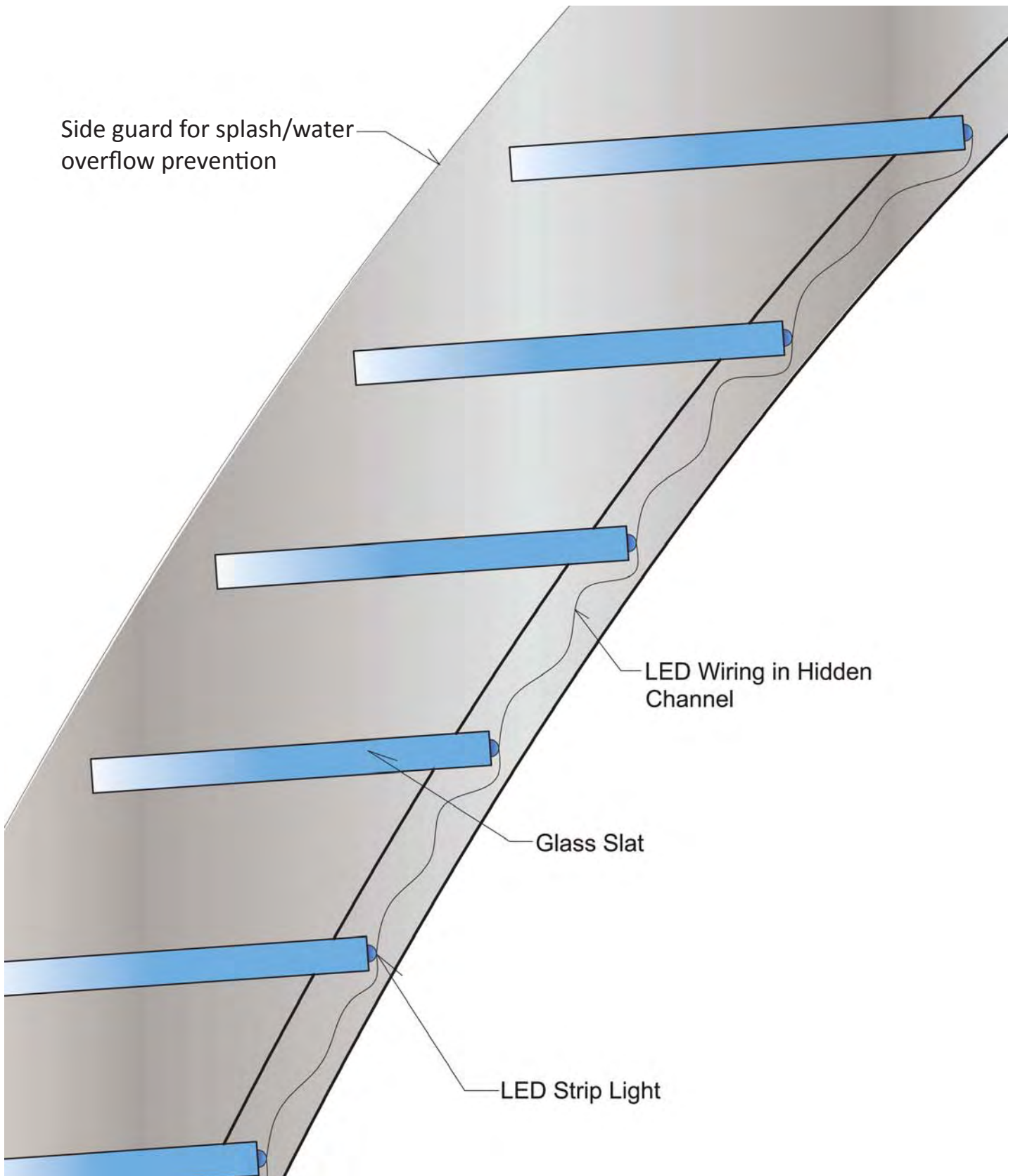

# Sculpture Design: Bluff

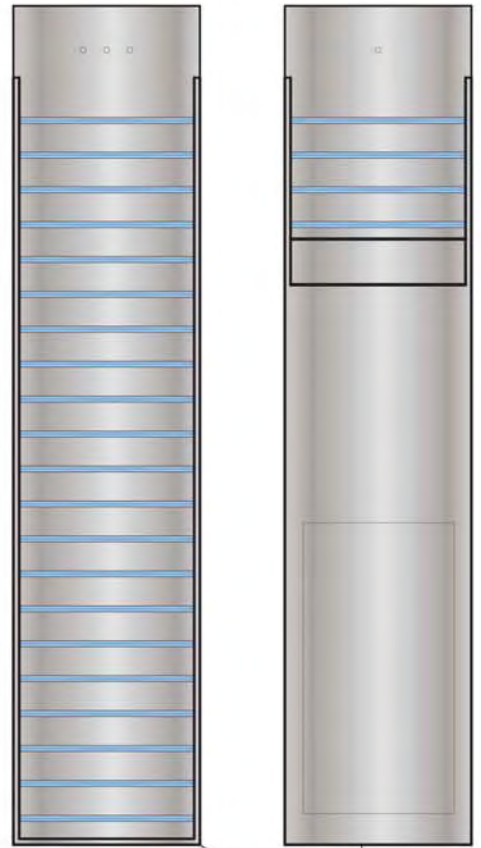
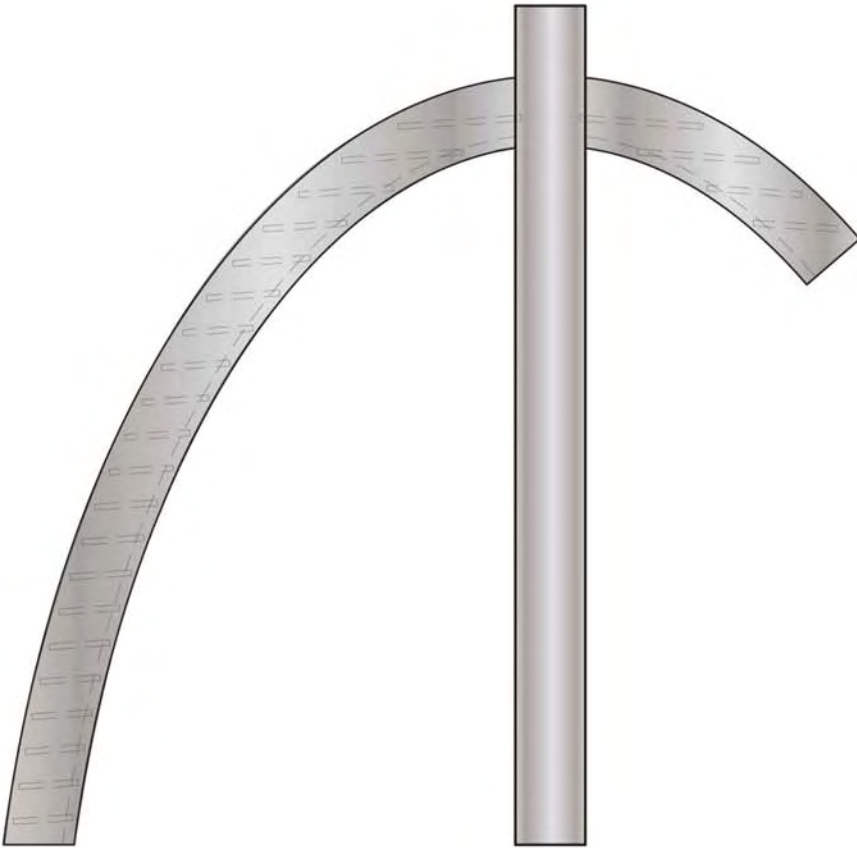

1 LED Sculpture - Side View  
3/4" = 1' 0"

2&3 LED Sculpture - Front & Rear View  
3/4" = 1' 0"



4 LED Sculpture - Top View  
3/4" = 1' 0"

# *Benches*



- “ParcVue” bench, by Landscape Forms
- Landscape Forms is a Chicago based company with manufacturing facilities in Michigan
- Fabricated with recycled steel
- Powdercoat finish resists chipping
- Frame forms mimic the arch in the sculpture and the design inspirations
- Finish to be either silver, which relates best to the sculpture design, or bronze which provides a beautiful update to the current Highland Park brown outdoor furniture.

Parc Vue is a fresh take on the classic Parisian bench. Curves sans curlicues and energy expressed in a few sure strokes make a beautiful design statement for our time.



The Landmark Collection of outdoor furniture was designed by a trio of celebrated designers and architects and inspired by familiar themes in historic design, architecture and nature. Designer John Rizzi took his inspiration from traditional cast iron furniture and asymmetric patterns in nature. The Parc Vue bench achieves a delicate balance between the strength and lively gesture of its frame and the perceived lightness and linear order of its slatted seat. It is a sculptural form that has what Rizzi calls "traditional roots and its own dynamic presence." In the companion curved and mesh-caged Parc Vue litter receptacle, the designer combines historic reference and contemporary manufacture in an elegant utilitarian object suited to a variety of settings in urban environments.

#### Parc Vue Specifications

#### Benches

Horizontal strap seat style is standard for backed or backless benches. Bench is available in 72" length. End arms are available for backed bench and are welded to the end frame.

Support end frames are of 3/4" steel. Seating surface is made of horizontal steel straps (1-1/2" x 3/16"), which are welded to the end frames. Parc Vue bench may be specified freestanding with glides or surface mount with anchor tabs.

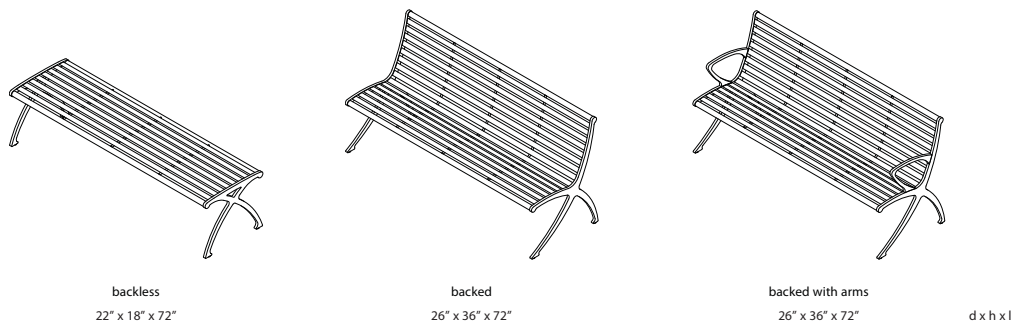

#### Finishes

Metal is finished with Landscape Forms' proprietary Pangard II polyester powdercoat, a hard yet flexible finish that resists rusting, chipping, peeling and fading. Call for standard color chart

#### To Specify Bench:

If Backed, choose with or without arm ends. Select freestanding or surface mount and powdercoat color.

landscapeforms.com

Visit our website for product details, pricing, color charts, technical sheets, sales office locations. Download JPG images, brochure PDF, CAD details, CSI specifications, and assembly instructions.

Specifications are subject to change without notice.  
 Parc Vue meets ANSI/BIFMA performance and safety standards.  
 Parc Vue is manufactured in U.S.A.  
 Parc Vue designs are protected by U.S. Patent Nos. D528,831; D548,916; D532,630; D534,021.  
 Parc Vue is designed by John Rizzi.  
 Location photography: Watercolor Resort, Santa Rosa Beach, FL.  
 Landscape Forms supports the LAF at the Second Century level  
 Copyright 2009 Landscape Forms, Inc. Printed in U.S.A.

landscapeforms®

800.521.2546 269.381.3455 fax  
 431 Lawndale Avenue, Kalamazoo, MI 49048  
 landscapeforms.com



Metal is the world's most recycled material and is fully recyclable. Consult our website for recycled content for this product. Powdercoat finish on metal parts contains no heavy metals, is HAPS-free and has extremely low VOCs.

# *Waste & Recycling Containers*



- “Chase Park” waste and recycling receptacles, by Landscape Forms
- Landscape Forms is a Chicago based company with manufacturing facilities in Michigan
- Fabricated with recycled steel
- Powdercoat finish resists chipping
- Frame compliments and updates the existing Highland Park waste containers
- Finish to be either silver, which relates best to the sculpture design, or bronze which provides a beautiful update to the current Highland Park brown outdoor furniture.

## Our Purpose Is To Enrich Outdoor Spaces

We believe in the power of design and its ability to influence and elevate the quality of public space. High quality products and outstanding customer experience makes us one of the world's premier designers and manufacturers of outdoor commercial furnishings.



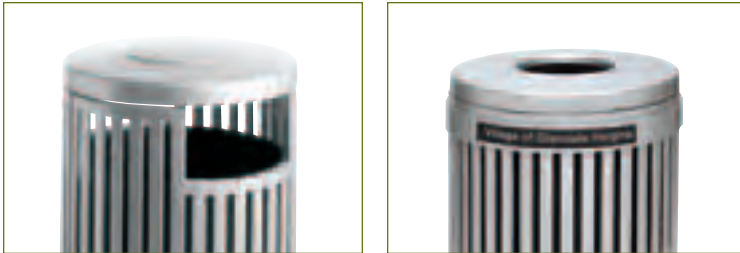

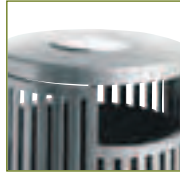

### Chase Park Litter Specifications



Chase Park receptacle features a hinged door that swings open allowing the liner to slide out for emptying. Constructed of cast aluminum sides and door, with spun aluminum top and cast iron base. Door hinge and latch are stainless steel. Top and side-opening receptacle can be freestanding or surface mounted. Logo band available with both top-opening and side-opening styles. Sand pan optional with side-opening unit. Capacity of the top-opening receptacle is 40 gallons, for side-opening, 36 gallons. An optional keyed lock may be specified. Custom fit polyethylene liner in black, standard with all receptacles.



### Litter Receptacles

			
Top-Opening	Side-Opening	Top-Opening with logo band	
24" x 39"	24" x 40"	24" x 39"	dia x h
			
Side-Opening with sand pan	Side-Opening with sand pan and logo band	Side-Opening with logo band	
24" x 40"	24" x 40"	24" x 40"	dia x h

### Finishes

All metal is finished with Landscape Forms' proprietary Pangard II polyester powdercoat, a hard yet flexible finish that resists rusting, chipping, peeling and fading. Call for standard color chart.

### To Specify:

Select top-opening or side-opening and powder-coat color. Specify with or without logo band and sand pan. Shipped with freestanding slides. Surface mount holes provided in base.

### [www.landscapeforms.com](http://www.landscapeforms.com)

Visit our website for product details, color charts, technical sheets, and sales office locations. Download JPG images, brochure PDF, CAD details, and CSI specifications.

Chase Park is designed by Kipp Stewart.  
Chase Park designs are patented by U.S. Patent Nos. D472,357, D481,507  
Specifications are subject to change without notice.  
Chase Park is manufactured in U.S.A.  
Landscape Forms supports the Landscape Architecture Foundation  
at the Second Century level.  
© 2005 Landscape Forms, Inc. Printed in U.S.A.



Metal is the world's most recycled material and is fully recyclable. Powdercoat finish on metal parts contains no heavy metals, is HAPS-free and has extremely low VOCs. Contact us for more information regarding the recycled content of this product.

### landscapeforms®

800.521.2546 269.381.3455 fax  
431 Lawndale Ave., Kalamazoo, MI 49048  
[www.landscapeforms.com](http://www.landscapeforms.com)

# Lighting



- “Hawthorne” LED Lighting, by Landscape Forms
- Landscape Forms is a Chicago based company with manufacturing facilities in Michigan
- Fabricated with recycled steel
- Powdercoat finish resists chipping
- LED lighting has an extremely low energy draw
- Shielded light source provides adequate ground lighting while preventing sky glare
- Finish to be either silver, which relates best to the sculpture design, or bronze which provides a beautiful update to the current Highland Park brown outdoor furniture.







## hawthorne

The three-foot-tall Hawthorne pathway light echoes the design of its taller companion. Its multiple posts spread as they rise from their base to house a 8-watt LED luminaire sealed with thermoformed lens. Like Alcott, Hawthorne is finished in durable polyester powdercoat.



[landscapeforms.com](http://landscapeforms.com)

landscapeforms®

800.521.2546

269.381.3455 fax

431 Lawndale Avenue, Kalamazoo, MI 49048

Concord: Melville, Alcott, Hawthorne, Emerson, Poe — Designs are Patent Pending



Landscape Forms is proud to specify FSC and Green-e certified paper. This paper meets the Forest Stewardship Council's standards for responsible forest management and is made using certified renewable energy.



Metal is the world's most recycled material and is fully recyclable. Consult our website for recycled content for this product. Powdercoat finish on metal parts contains no heavy metals, is HAPS-free and has extremely low VOCs.

# *Pavers*



- “Eco-Priora”, Color “Coffee Creek”, by Unilock
- Pervious paver allows rain water to pass through and be absorbed into the soil below
- Reduced maintenance when compared to existing turf; less grass to mow
- Reduced rain water run off
- Increased rain water absorption
- Naturally filters rain water before it enters the treatment system
- Color is a close match to the existing Highland Park bricks
- Product has been successfully installed locally at Grant Park and Dominican University

# ECO-PRIORA™

ATTRACTIVE & ENVIRONMENTAL

**E**co-Priora™ is the latest introduction into the permeable paving stone market. Available in multiple shapes, this new permeable paver is also produced using face-mix technology that will increase the durability and provide better color retention. Custom colors and finishes are available to offer unlimited design possibilities. Combined with a surface infiltration rate of up to 140 inches per hour, Eco-Priora provides both aesthetics and environmental performance.

Manufactured in North America.



## COLORS & PACKAGING



Coffee Creek



Heritage Brown



10" X 10" x 3 1/8"  
24cm x 24cm x 8cm



5" X 10" x 3 1/8"  
12cm x 24cm x 8cm



5" X 5" x 3 1/8"  
12cm x 12cm x 8cm

All measurements are nominal

Stones & Bundling	Unit Thickness	Sq. Ft./ Bundle	Sections/ Bundle	Sq. Ft./ Ln. Ft. (Sailor)	Ln. Ft./ Bdle (Sailor)	Lbs./ Bundle	Units / Bundle
Large Square	3 1/8" (8cm)	86.6	-	0.618	110	3098	140
Rectangle	3 1/8" (8cm)	74.59	-	0.785	96	2668	245
Medium Rectangle	3 1/8" (8cm)	74.59	-	0.385	192	2668	290

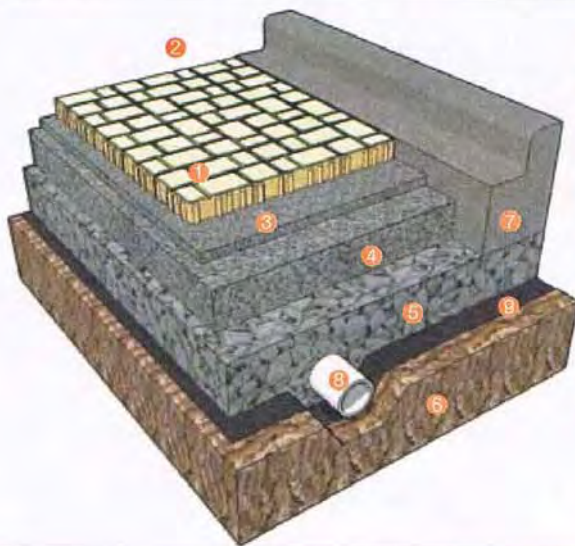

- 1 ECO-PRIORA™
- 2 JOINT AGGREGATE  
ASTM NO. 8
- 3 SETTING BED AGGREGATE  
ASTM NO. 8
- 4 BASE AGGREGATE  
ASTM NO. 57
- 5 SUBBASE AGGREGATE  
ASTM NO. 2
- 6 SUBGRADE
- 7 EDGE RESTRAINT
- 8 UNDERDRAIN
- 9 GEOTEXTILE FABRIC

## EXCLUSIVE FEATURES

### • HIGH INFILTRATION RATE

Eco-Priora™ has an infiltration rate up to 140 inches per hour while maintaining joint openings compliant with ADA guidelines.

### • RECTILINEAR DESIGN

The rectilinear design creates a sophisticated look and feel. Great for residential or commercial applications!

### • MULTI SHAPES

Eco-Priora™ is available in (2) or (3) sizes allowing you to create interesting designs.

### • MICRO-BEVEL EDGE

Gives you a sleek modern appearance that is different from any other paver.

### • CUSTOMIZED TEXTURES AND COLORS

Select your own aggregate colors, sizes and background color to match any project. (Min. qty. required)

## LIFETIME GUARANTEE:

\*Unilock® provides a lifetime guarantee on the structural integrity of its paving stone to the original purchaser of the product for residential use. Material installed using our installation guidelines that proves defective will be replaced without cost. Color matching cannot be guaranteed, and replacement labor is not included.

© 2009 Hengestone Holdings, Inc.

www.unilock.com | 1-800-UNILOCK

UNILOCK®

BOSTON BUFFALO CHICAGO CLEVELAND DETROIT MILWAUKEE NEW YORK PHILADELPHIA TORONTO

# Informational Signs



- Custom signs designed and fabricated by Green Living Designs, Globus Construction and NLH Landscape Architects
- Overall size to be 18" W x 16" D x 18" H  
Total size per sign to be 2 sq. ft.
- Information will be sandwiched between two 1/2" sheets of 3-Form, Varia Eco-Resin
- The thickness of the material ensures durability and protection against potential breaking and vandalism
- Sandwiching the information protects it from weather, wear and vandalism
- Frame to be stainless steel



Front View

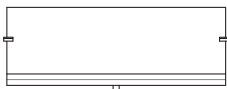

Side Profile

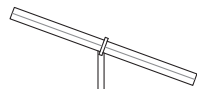

Top View

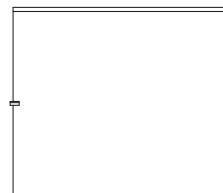

Rear View

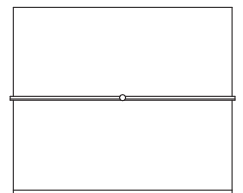

Signs mounted to 42" x 8" concrete sonotubes for stability

# Informational Signs

Graphics and images here

Information detailed here

Information detailed here

Information detailed here

Information detailed here

Information detailed here

- Information regarding one specific eco-friendly aspect of the park will be provided on one sign conveniently located adjacent to the specific aspect being described on the sign

- Potential layouts for the proposed signs are shown here with an example below

Graphics and images here

Information detailed here

Information detailed here

Graphics and images here

Information detailed here

Information detailed here

Graphics and images here

Information detailed here

Information detailed here

Information detailed here

Information detailed here

Information detailed here

Information detailed here

Graphics and images here

## Pervious Paving Bricks

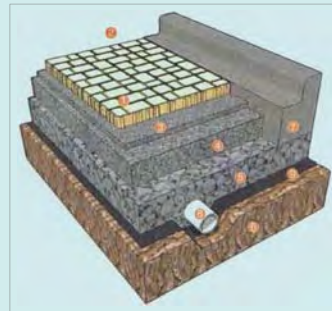

- 1 ECO-PRIORA™
- 2 JOINT AGGREGATE  
ASTM NO. 8
- 3 SETTING BED AGGREGATE  
ASTM NO. 8
- 4 BASE AGGREGATE  
ASTM NO. 57
- 5 SUBBASE AGGREGATE  
ASTM NO. 2
- 6 SUBGRADE
- 7 EDGE RESTRAINT
- 8 UNDERDRAIN
- 9 GEOTEXTILE FABRIC

# Plants



• Peking Cotoneaster



• Skyline Thornless Honeylocust



• Fountain Grass



• Gro-Low Sumac



• Bertram Anderson Sedum

- All plants are perennial, native plants
- Acclimated to withstand local climate including summer heat, drought and brutal winters
- Provide seasonal color
- Reduced waste, maintenance and costs when compared to annuals
- Limited growth contributes to reduced maintenance

# *Conceptual Rendering*



# *Time Line*

- Design Review Commission
- Fundraising
- Creation of construction documents for bids and permits
- Finalizing contractors and vendors
- Fabricate sculpture and complete ordering of site furniture
- Site clearing and preparation
- Footings for benches, electrical and plumbing
- Pavers, sculpture, waste receptacles installed
- Planting
- Total construction estimated to be completed six to eight weeks from start



# *Responsibilities*

- Imperial Realty has agreed to continue with their current responsibility of mowing and maintaining any turf grass
- Green Living Designs and Globus Construction will maintain ownership of the sculpture and bear all responsibility for its upkeep
- Green Living Designs and Globus Construction has agreed to accept responsibility for maintaining and servicing any electrical and plumbing components above and beyond what may reasonably be expected to be included with a park design
- We request that the City of Highland Park integrate the garden into its annual downtown maintenance to provide sweeping and power washing of the pavers
- Estimated costs are approximately \$ 85,000.00. At this time, we estimate that we will fund the park with a combination of private donations, public and private grants and funding, and vendor discounts and donations.



**GREEN** *Living* Designs  
**GLOBUS** *Sustainable* Construction

